

BUILDING 3 — 7355 MORTON AVENUE

±76,162 SF

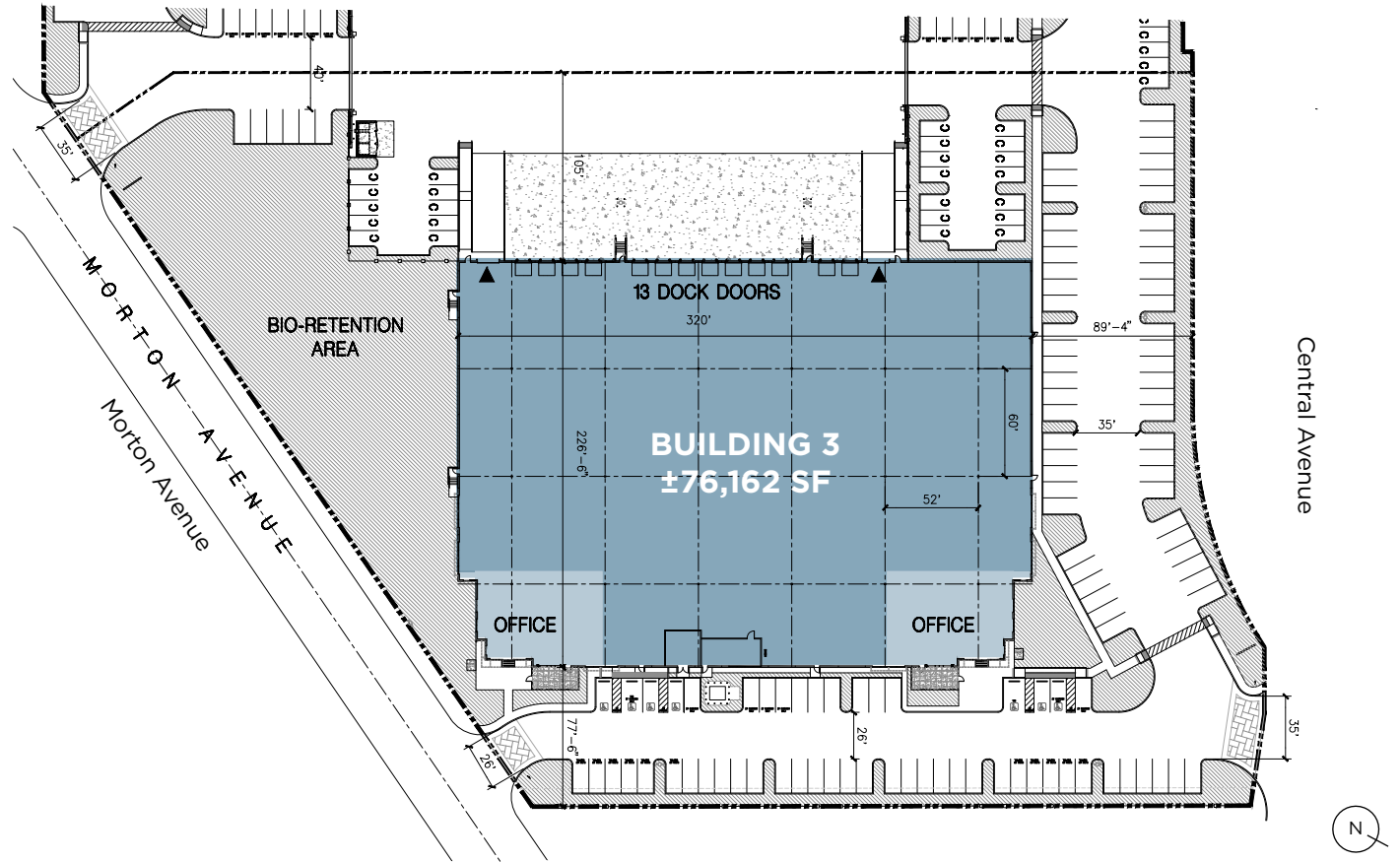

Building Features

- ±76,162 SF
- 13 dock doors / 2 grade level doors
- 136 parking spaces
- 30' clear
- ESFR Ready sprinkler system
- 100% solar ready roof
- 2500 AMPS underground pull section
- Office to-suit, 5,000 SF of second story office
- 2.5% Skylight Ratio

©2018 Cushman & Wakefield. NO WARRANTY OR REPRESENTATION, EXPRESS OR IMPLIED, IS MADE TO THE ACCURACY OR COMPLETENESS OF THE INFORMATION CONTAINED HEREIN, AND SAME IS SUBMITTED SUBJECT TO ERRORS, OMISSIONS, CHANGE OF PRICE, RENTAL OR OTHER CONDITIONS, WITHDRAWAL WITHOUT NOTICE, AND TO ANY SPECIAL LISTING CONDITIONS IMPOSED BY THE PROPERTY OWNER(S). AS APPLICABLE, WE MAKE NO REPRESENTATION AS TO THE CONDITION OF THE PROPERTY (OR PROPERTIES) IN QUESTION.